

# TECHNICAL DATA SHEET

## INDOOR/OUTDOOR VERTICAL GARDEN OPEN CIRCUIT

**SIDE VIEW**

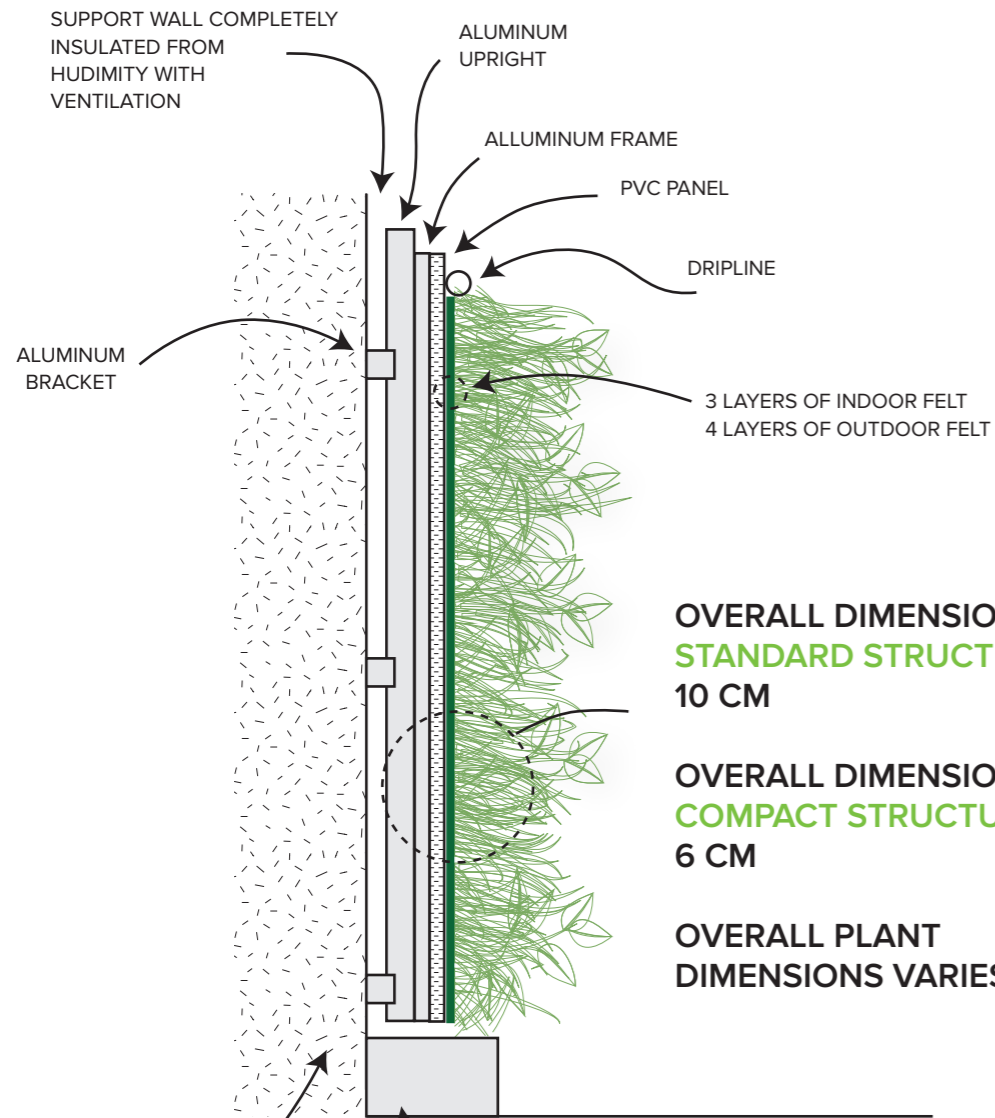

OVERALL DIMENSIONS OF  
**STANDARD STRUCTURE + PLANTS**  
10 CM

OVERALL DIMENSIONS OF  
**COMPACT STRUCTURE + PLANTS**  
6 CM

OVERALL PLANT  
DIMENSIONS VARIES BY PROJECT

- SUPPORT WALLS IN :
- REINFORCED CONCRETE
  - BRICK
  - PLYWOOD
  - PLASTERBOARD

ALUMINUM WATER COLLECTING TANK PAINTED WITH RAL CODE COLORS WITH GRILL AND FILTERS DIMENSIONS 120x150x LENGTH (MM)

**FRONT VIEW**

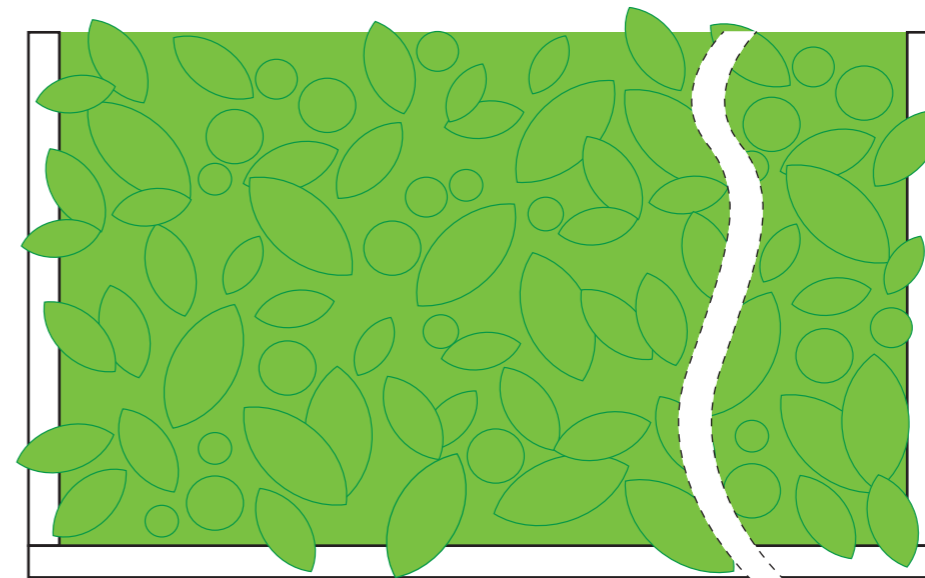

LATERAL BEAM IN PAINTED ALUMINUM TO RUN TUBES AND FOR SYSTEM MAINTENANCE

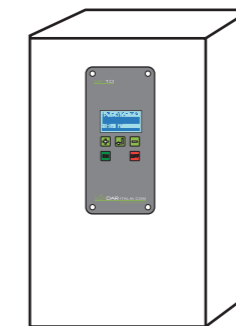

### TECHNICAL COMPARTMENT

- CONTROL UNIT
- IRRIGATION WITH SOLENOID VALVES
  - FERTILIZER
  - SANITATION
  - REMOTE MANAGEMENT
  - GSM / WIFI
- WATER SUPPLY AND 230V AC ELECTRICITY NECESSARY

**PLAN VIEW**

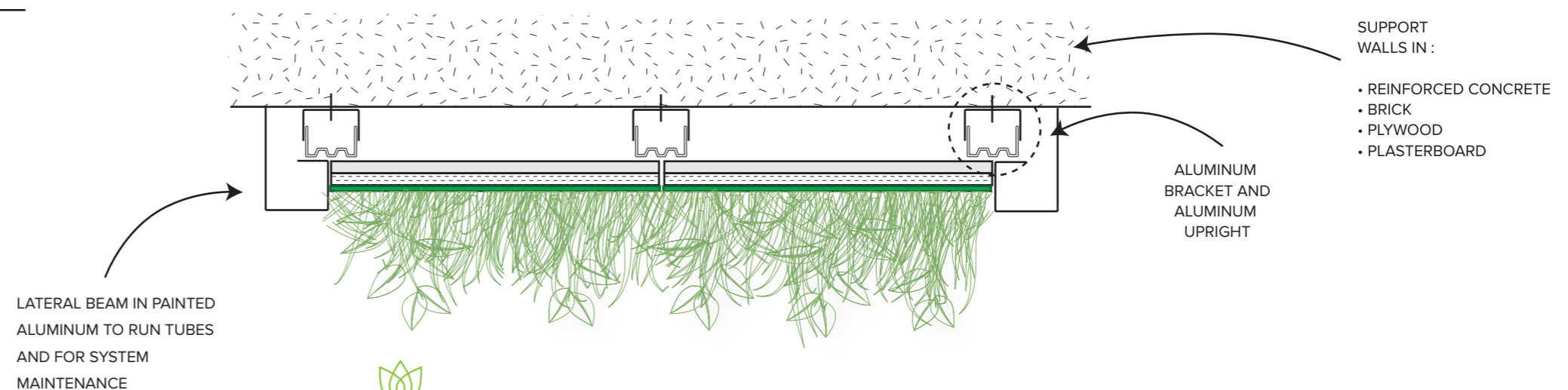

**SUNDAR**

ITALIA

GIARDINI VERTICALI

# TECHNICAL DATA SHEET

INDOOR/OUTDOOR VERTICAL GARDEN  
OPEN CIRCUIT



**main structure in aluminum**

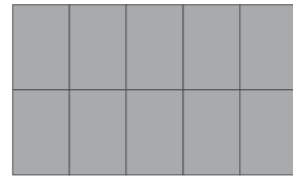

**aluminum frame and structure in PVC**

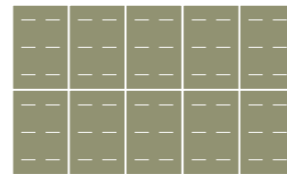

**felt**



**plants**

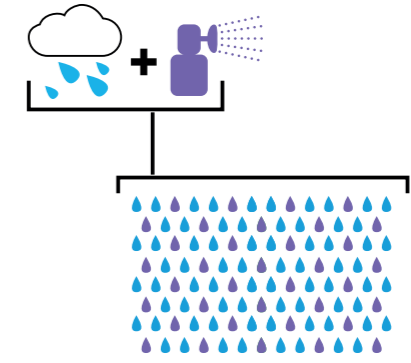

**fertilization/irrigation system**

Daily water consumption  
**1/2 L\* per day per 1 m<sup>2</sup>**

## Ecosystem services: urban scale effects

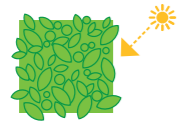

### Urban Heat Island and Urban Canyons

The Living Wall limits the effects of wall and street surfaces that reflect solar irradiation and materials that absorb heat, also thanks to plant evapotranspiration



### Augmented green space

The vertical shape of the Living Wall provides opportunities for plant colonization in cities



### Perception of temperature and climate comfort

The Living Wall induces the perception of lower temperatures even when these are not actually detected by devices



### Urban area redevelopment

The Living Wall can contribute to attracting social life in abandoned urban spaces



### Acoustic impact

The Living Wall can decrease indoor noise and outdoor echo



### Visual communication

The Living Wall allows for the renewal and redesign of existing buildings



### Air quality

The Living Wall can remove atmospheric pollutants such as sulfur dioxide (SO<sub>2</sub>), ozone (O<sub>3</sub>), nitrogen dioxide (NO<sub>2</sub>) and particulate matter



### Urban biodiversity

A careful selection of plants can attract birds and increase urban biodiversity

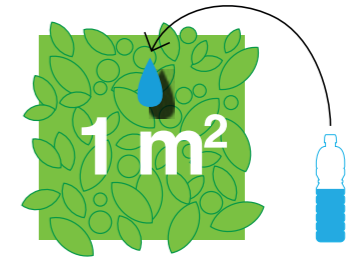

(PM10, for example)